

# LIGHT BIMETALLIC THERMOMETERS



Suitable for use on food processing equipment, the completely sealed stainless steel stem make Rototherm light bimetallic thermometers the ideal choice. Perspex can be supplied in place of glass if required.

If pressures above 3.5 bar are likely to be encountered, a thermowell must be used.

## SPECIFICATION

### BL1 Series

<b>CASE</b>	65 mm diameter, splashproof, corrosion resistant stainless steel to BS970 : 304S15
<b>DIAL</b>	63 mm diameter, non ferrous metal clearly marked to BS3693
<b>STEM</b>	8mm diameter, stainless steel to BS970:316S16 Completely sealed for direct immersion into medium.
<b>IMMERSION</b>	Minimum immersion depends on temperature range See table
<b>ACCURACY</b>	±1% of F.S.D.

### BL2 01

A special model for mounting on ovens, sterilizers, cabinets etc. where their is insufficient space for BL1.	
<b>CASE</b>	54 mm diameter, stainless steel to BS970 : 304S15
<b>DIAL</b>	50 mm diameter, non ferrous metal clearly marked to BS3693
<b>STEM</b>	5 mm diameter, stainless steel to BS970:316S16 Completely sealed for direct immersion into medium.
<b>IMMERSION</b>	Minimum immersion depends on temperature range See table for BL1 series
<b>ACCURACY</b>	±1% of F.S.D.

## TEMPERATURE RANGES

Temperature Range		Minimum Immersion
Celsius	Fahrenheit	mm
-30 / +60	-20 / +140	60
10 / 120	50 / 250	55
0 / 160	0 / 300	45
50 / 250	100 / 400	45
0 / 400*	0 / 800	55

\* Not Available on BL2 01

## DIMENSIONS

### BL1 01 with 1/2" BSP boss

For direct fitting to pipelines or tanks by integral 1/2" BSP boss. Standard insertion length L = 40, 55 or 75mm. Note that the boss is relieved internally to allow required stem length to be exposed to medium.

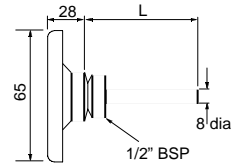

### BL1 02 with Thermowell

Complete with thermowell to enable thermometer to be removed without draining the system. Standard thermowell is solid machined brass 12.7mm diameter with 1/2" BSP fitting. For use above 160° the option of mild or stainless steel is recommended

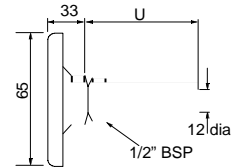

### BL1 03 plain stem

Can be used without fixing in place or with compression gland to seal thermometer at any required immersion in tank, pipeline or thermowell. Standard stem length : 150mm. Option - length up to 1000 mm.

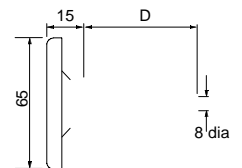

### BL1 04 backnut fitting

Flush fitting with 3/8" BSP boss and backnut and rubber sealing ring for use on ovens, sterilizers etc... Standard stem length : 150mm. Option - length up to 1000 mm.

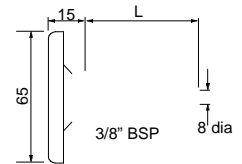

### BL1 05 flange fitting

Flange fitting for use on ovens, sterilizers etc. Standard stem length 150mm. Option stem length up to 1000mm

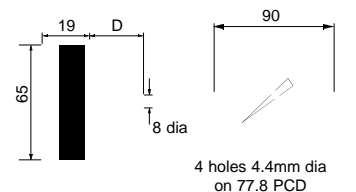

### BL2 01 50mm dial with boss

Special model for mounting on ovens, sterilizers, cabinets etc... where there is insufficient space for BL1. Flush fitting with 3/8" BSP boss and backnut. Standard stem length : 75mm. Option - length up to 200 mm.

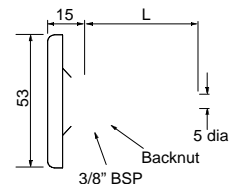

## ORDER CODE

<b>63mm dial 1/2" BSP boss</b> Insertion length "L" : 40, 55 or 75mm Temperature Range from table	BL1 01	<input type="checkbox"/>	<input type="checkbox"/>
<b>63mm dial thermowell</b> Insertion length "L" : 40, 55 or 75mm Temperature Range from table <b>Thermowell material</b> Brass (standard) _____ B Mild Steel _____ MS Stainless steel _____ SS	BL1 02	<input type="checkbox"/>	<input type="checkbox"/>
<b>63mm dial plain stem</b> <b>63mm dial boss &amp; nut</b> <b>63mm dial, flanged</b> Stem length in mm (150mm is standard) _____ Temperature Range from table	BL1 03 BL1 04 BL1 05	<input type="checkbox"/>	<input type="checkbox"/>
<b>50mm dial 3/8" BSP boss</b> Stem length in mm (150mm is standard) _____ Temperature Range from table	BL2 01	<input type="checkbox"/>	<input type="checkbox"/>

**Rototherm**  
instrumentation and control

British Rototherm Co. Ltd.,  
Kenfig Industrial Estate, Margam,  
Port Talbot, West Glamorgan,  
SA13 2PW, United Kingdom  
Tel: 01656 740551 Fax: 01656 745915  
E-mail: rototherm@rototherm.co.uk  
Web site: www.rototherm.co.uk



BS EN  
ISO 9001  
Registration  
no: FM11958