

Model **SYPHON****Syphon** Stainless Steel

Pressure Gauge Accessory

Design Features

- Pigtail and "U" Type Designs available
- Maximum temperature up to 400 Deg C
- Nominal Pressure up to 160 bar

Introduction

Syphons are used to protect pressure instruments from coming into direct contact with high temperature process fluids or vapours.

Mounted between the process and the pressure instrument - the syphon acts to protect the instrument from process pulsation and to generate a cooling effect.

Specifications**Body Material**

AISI 316 stainless steel

Operating Pressure100 kg/cm² at 120°C**Dimensions in mm****Coil Type**

Pipe Size	A	Ø B	Ø C	Ø D	E
1/2" Sch. 40	270	61.5	21.3	15.7	25
1/2" Sch. 80	270	61.5	21.3	13.9	25
1/2" Sch. 160	270	61.5	21.3	11.7	25

A* = ±5.0 mm

Pigtail Type

Pipe Size	A	Ø B	Ø C	Ø D	E
1/2" Sch. 40	270	61.5	21.3	15.7	25
1/2" Sch. 80	270	61.5	21.3	13.9	25
1/2" Sch. 160	270	61.5	21.3	11.7	25

A* = ±5.0 mm

"U" Type

Pipe Size	A	B	U	Ø C	Ø D	E
1/2" Sch. 40	169	155	99	21.3	15.7	25
1/2" Sch. 80	169	155	99	21.3	13.9	25
1/2" Sch. 160	169	155	99	21.3	11.7	25

A* = ±5.0 mm

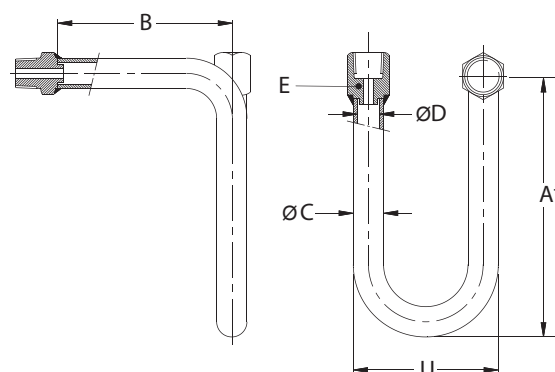
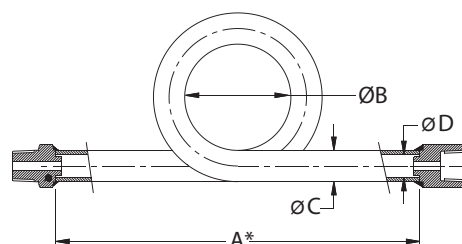
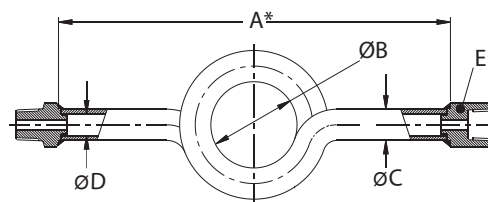

ISO9001:2008

British Rototherm Company Limited

Kenfig Industrial Estate, Margam, Port Talbot SA13 2PW United Kingdom

Telephone : +44 (0) 1656 740 551**E-mail** : sales@rototherm.co.uk**Facsimile** : +44 (0) 1656 745 915**Web Site** : www.rototherm.co.uk